

70UL3E
60UL3E

Clear Color Expression of UHD Content

UL3E

The UL3E series delivers Ultra HD content in vivid colors and with fine details, giving audiences a clearer viewing experience in a large, beautiful display. With its ease of management and compatibility with automated control systems like Crestron and Extron, the UL3E series can help employees fully concentrate on critical work tasks instead of taking extra time to manage device connections.



Clear Color Expression of UHD Content

UL3E

Superior Picture Quality

True Color, Wide View

LG IPS panel features a wide viewing angle to deliver clear content regardless of where meeting participants are seated. Each pixel in the IPS panel reproduces image colors true-to-life, without distortion.



Vivid Color Details with Ultra HD

The UHD resolution allows users to view details even when zooming in on the display, with four times higher definition than FHD. The UL3E ensures stable UHD video playback with HEVC (High Efficiency Video Coding).

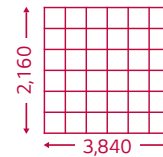

ULTRA HD

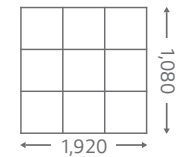

FULL HD

Clear Color Expression of UHD Content

UL3E

Content Management Without a PC

LG Simple Editor

You can create content easily using embedded templates that provide customizable elements, including images, text, videos, backgrounds, and external input signals. Once a playlist is set, LG Simple Editor can be set to distribute the playlist to several displays via network connection or USB connection.

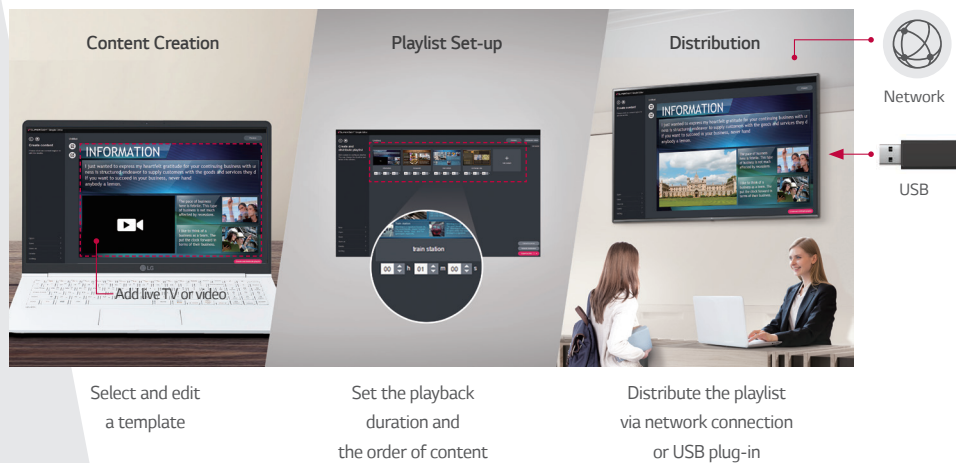

USB Data Cloning

USB data cloning makes managing multiple displays more efficient for optimal operation, since users don't have to set up each display one by one. Once users copy data to a USB from one display, it can be easily distributed to other displays through the USB connection.



Clear Color Expression of UHD Content

UL3E

Advanced Compatibility

Compatibility with Automated Control Systems

The UL3E series has been certified Crestron Connected[®] for a higher level of compatibility with professional AV controls to achieve seamless integration and automated control¹, boosting business management efficiency.



1) Network based control

Compatibility with Video Conferencing Systems

For the optimum visual meeting, the UL3E has certified its compatibility² with Cisco Spark Room Kits. The picture quality is automatically adjusted for video conference, reducing a time to coordinate multiple devices.



2) Enabled through the HDMI cable connection.

Clear Color Expression of UHD Content

UL3E

Easy Management

Real-Time Remote Monitoring

In case of malfunctions or errors, real-time remote care is available. When an error occurs, a notification can be sent through the SNMP(Simple Network Management Protocol).



Power & Network in One Line

WOL (Wake-on-LAN) enables users to send a message through network to turn on displays. This greatly simplifies the installation and maintenance processes as only a single wire is required for power and network connection.



Dimensions

70"

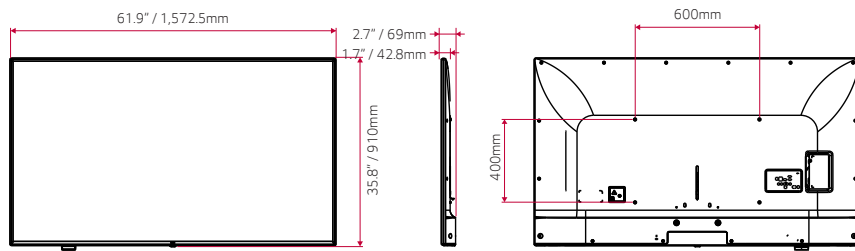

60"

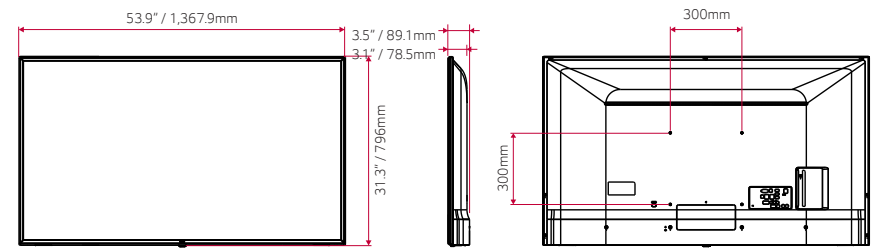

Connectivity

70"

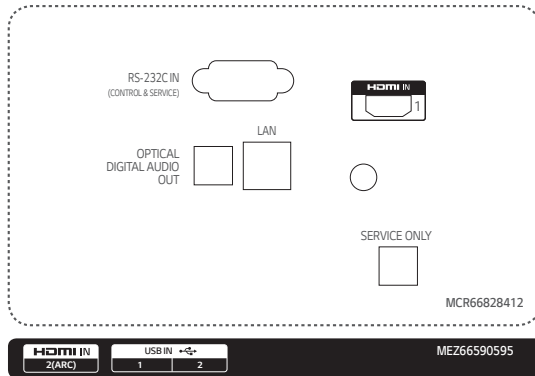

60"

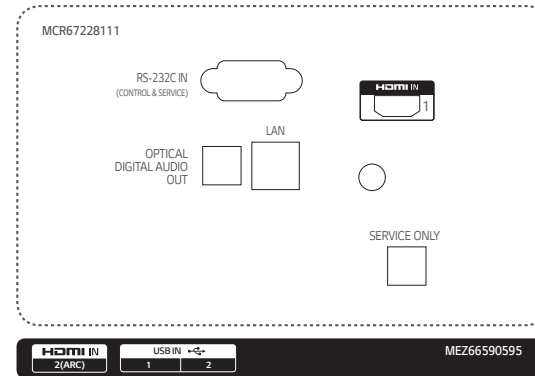

* Dimensions & Jack Panels (Rear/Side) may differ from the above image, so please contact LG salesteam to verify before ordering.

Specifications

		70UL3E	60UL3E
PANEL	Screen Size	70"	60"
	Panel Technology	VA	VA
	Aspect Ratio	16:9	16:9
	Native Resolution	3,840 x 2,160 (UHD)	3,840 x 2,160 (UHD)
	Brightness (Typ.)	400 nits	400 nits
	Contrast Ratio	4,000:1	4,000:1
	Viewing Angle (H x V)	176° x 176°	176° x 176°
	Response Time	8 ms (G to G)	8.8 ms (G to G)
	Surface Treatment	Haze 5%	Haze 5%
	Life Time (Typ.)	30,000 Hrs	30,000 Hrs
	Operation Hours	16 Hrs	16 Hrs
Orientation	Landscape	Landscape	
CONNECTIVITY	Input	HDMI (2), USB 2.0 (2)	
	Output	Audio (Optical)	
	External Control	RS232C In, RJ45 In	
PHYSICAL SPECIFICATIONS	Bezel Color	Meto Titan	Cramic Black
	Bezel Width (Off-Bezel)	15.3 mm (T/L/R), 20.4 mm (B)	17.7 mm (T), 17.5 mm (L/R), 21.4 mm (B)
	Monitor Dimension (W x H x D)	61.9" x 35.8" x 2.7" / 1,573 x 910 x 69.0 mm (w/Speaker)	53.9" x 31.3" x 3.5" / 1,368 x 796 x 89.1 mm (w/Speaker)
	Weight (Head)	71.7 lbs / 32.5 kg	42.8 lbs / 19.4 kg
	Carton Dimensions (W x H x D)	66.2" x 42.3" x 6.9" / 1,682 x 1,075 x 175 mm	58.7" x 34.6" x 7.5" / 1,492 x 880 x 190 mm
	Packed Weight	91.1 lbs / 41.3 kg	55.8 lbs / 25.3 kg
	VESA™ Standard Mount Interface	600 x 400 mm	300 x 300 mm
SPECIAL FEATURES	Local Key Operation, Auto Brightness Sensor, webOS (TV UI, w/o SCAP), Lock Mode, Setting Data Cloning (USB), SNMP (Ver. 1.4) Crestron Connected ^{®1} , Cisco No Touch Set-up ² , DPM, Power on Status, Wake on LAN, HDMI-CEC ³ , Built-in Speaker (10Wx2)		
ENVIRONMENT CONDITIONS	Operation Temperature	32°F to 104 °F / 0°C to 40°C	32°F to 104 °F / 0°C to 40°C
	Operation Humidity	10% to 80%	10% to 80%
SPECIFICATIONS	Power Supply	100-240V~, 50/60Hz	100-240V~, 50/60Hz
	Power Type	Built-In Power	Built-In Power
	Power Typ. Consumption	140 W	112 W
	Power Max. Consumption	270 W	205 W
CERTIFICATION	Safety	UL	UL
	EMC	FCC Class A	FCC Class A
	ErP	Energy Star 7.0	Energy Star 7.0
SOFTWARE COMPATIBILITY ⁴	Content Management Software	SuperSign CMS	SuperSign CMS
	Control and Monitoring Software	SuperSign Control / Control+	SuperSign Control / Control+
OTHER	Accessories	Remote Controller (Batteries Included), QSG, Safety Manual	Remote Controller (Batteries Included), Power Cord, QSG, Safety Manual
	UPC	19192 62501 3	7 19192 62455 9

1) Network-based control.
 2) The HDMI connection based.
 3) Compatibility may differ by equipment.
 4) Software compatibility may change over time.
 Please contact LG sales representative for details.

* Dimensions & Jack Panels (Read/Side) may differ from the above image, so please contact LG sales team to verify before ordering.

* Specifications are subject to change without notice, so please contact LG salesteam to verify before ordering.